

Private Treaty Bull Sale



We will be selling the first sons of Diamond BREAKOUT 205C as well as Riverbend Consensus Y1514 and other Jensen Angus Herd sires.

Saturday, February 10, 2018

Private Treaty Sale starts at 10:00AM

Bulls sold on first come-first serve basis until all bulls sold. Coffee & donuts at 10AM.

**Jensen Angus Corrals, Grable Lane
Boulder, Wyoming**



Jensen Angus

High Mountain Quality Bulls

Saturday

February 10, 2018

Sale starts at 10:00AM MST

Sale Day Phones

Justin cell: 307-360-6293

Renee cell: 307-360-9136

Sale Location Directions

At Boulder, Wyoming, turn off US 191 east onto Hwy 353. Watch for signs. Travel east approximately 2.4 miles to Boulder Canal Rd. Turn right (south) and travel approximately one mile. Turn right (west) onto Grable Lane. The Jensen Bull Sale corrals will be on the right. Plenty of parking available for trailers.

Liability

All persons who attend the sale do so at their own risk.

Terms and Conditions

Bulls sell under the terms and conditions of the American Angus Association

Supplemental Data

Bull sale weights, as well as scrotal and fertility report cards will be available sale day.

Bull Viewing

Available any time before the sale at the Grable Lane corrals. Watch for signs on sale day.

Refreshments

Donuts and coffee starting at 10:00AM

PAP Scores

UNIQUE TO JENSEN ANGUS is that the sale bulls will have two PAP scores, one taken October 8, 2016 and the other as 18 month old bulls on December 8, 2017. Our PAP testing is done by Dr. Tim Holt, DVM.

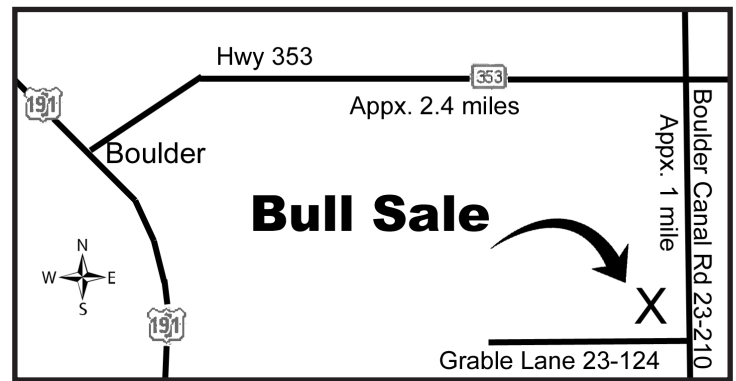

Health

Our herd health protocol starts with our calves. Branding we use Vision 8, Vista Once and Multi Min 90. As weaned calves they are given Vision 8, Nasalgen, Multimin 90, Pyramid 5 Preponce, and poured. We have Dr. Tim Holt as our vet for PAP testing and consulting on all aspects of high altitude herd management. We poured the bulls in December when we PAP tested. Our local veterinarian is Dr. Tripp Applequist of Farson, WY. He does our fertility testing and BVD and Trich testing. The sale bulls were tested on December 18, 2017. We take great measures to have a good healthy herd of cattle!

Guarantee

First Year Breeding Guarantee:

All bulls selling in the sale are guaranteed sound, free from any genetic defect, and in good health. Our guarantee is for the first breeding season defined as a 90 day period following the first turnout of the bulls. All bulls selling for \$5,000 or more will be covered 50% by Jensen Angus if they are injured during their first breeding season and unable to return to service during that first breeding season. Example: If a \$5,000 bull is injured, then a credit of \$2,500, minus one half of any salvage value, will be given to the buyer. ALL INJURED BULLS MUST BE DIAGNOSED BY A VETERINARIAN. Please notify us as soon as possible. All claims must be made by October 1, 2018. Please notify us as soon as possible if any injury occurs and also prior to the bull being sold for salvage.

Delivery

Please bring your trailers on sale day and make every effort to take bulls with you.

PAP Testing

By Dr. Tim Holt

Brisket Disease, also known as High Mountain Disease or Dropsy, is one of the Rocky Mountain region's most costly diseases. The disease is the result of elevated pulmonary arterial pressure caused from lack of oxygen and generally affects only animals at an elevation above 5000 feet.

Cattle differ in how they respond to oxygen shortage. Some are able to tolerate high pressures for a long period of time, while others die quickly. Brisket disease is not limited to one sex or breed, and has been found across all breeds including crossbreeds.

Pulmonary arterial pressures (PAP) are obtained by a procedure called "right heart catheterization." In this procedure, a fine plastic catheter is passed through a needle in the jugular vein, with blood flow into the upper right side of the heart, through a valve, into the right ventricle, through a valve, and into the pulmonary artery just short of the branches to the lungs. Pressure waves are observed on a heart monitor and the monitor gives a direct readout of the true average pressure.

There are two major concerns when evaluating PAP measurements in cattle. The first is the elevation of the test as previously discussed. The second is the age of the animal. Generally the older the animal at the time of testing the more accurate the PAP test. Any animal 11 months of age or older can be tested with a high degree of accuracy and repeatability. **We have found that those animals greater than 14 months of age tend to be very accurate and reliable.**

The PAP test is the best indicator (tool) available to date for identifying animals predisposed to Brisket Disease. The test is not 100% and should not be used as such. Generally, cattle with pressures of greater than 45 mmhg are considered at risk but other criteria such as age and elevation of test site should be considered. **Test scores are not consistently accurate unless done at 6500 feet elevation or higher.**

Research has shown that the heritability of Brisket Disease can be quite high, ranging from 42% - 84%. This indicates that cattlemen can successfully select against the disease by culling cattle with high pulmonary

arterial pressures. In efforts to cut losses to Brisket Disease, cattlemen should identify those animals, specifically bulls, with high pulmonary arterial pressures and cull them from the herd or avoid adding them to the herd.



Jensen Angus
High Quality Mountain Bulls

Healthy Heart/Brisket Disease

We dissected a healthy heart and a brisket diseased heart when we PAP tested. This video will be shown sale day during the preview of the bulls.

The Jensen Angus Difference

This is What We Do and Why We Do It!

We concentrate on having high altitude cattle that can perform well in any commercial situation. We develop our bulls with this in mind. They are structurally sound and easy fleshing, with a lot of natural muscle bred into them, not having been fed into them. Our bulls are active breeders that are able to cover cows and not “shade up” when they are turned out. They are genetically influenced to ensure a reliable PAP score to thrive at elevations greater than 6,500 feet.

The biggest difference is that we PAP test our heifers and the dams of our sale bulls. If you are truly committed to finding and remedying any problems with Brisket Disease in your herd, you must test your heifers! This single step has and will continue to be how we judge our replacements. All purchased heifers are PAP tested after at least a six month acclimation period. We do not just sell PAP tested bulls, we give you the whole genetic package, starting with the cow.

In summary, we want you to know that passion, hard work, and honesty go into everything we do at Jensen Angus. We are the “little herd that could”. We are a small family run operation. We do not think we know more or are better than any other seedstock producers, we just do things a little different. We just do high altitude cattle, period.

We would like to offer the opportunity to buy semen from our PAP tested sires at ORigen. Contact them for rates.

***We Look Forward to
Seeing You at the Sale!***



Jensen Angus

High Quality Mountain Bulls

ORigen

Semen Sales: 1.866.867.4436

www.origenbeef.org



Jensen Angus High Mountain Bulls

Spring 2018 Private Treaty Bull Sale

Tattoo	Birth Date	Reg. No.	Sire Name	MGS Name	Actual BW	BW EPD	WW EPD	YW EPD	MILK EPD	CW EPD	MARB EPD	PAP 1	PAP 2
Lot 1-679	18-Apr	18830 999	R. CONSENSUS	CONNEL GRIDLINE	87	+2.8	+57	+89	+25	+31	+65	37	38
Lot 2-6134	18-Apr	18830 997	R. CONSENSUS	SHAMROCKS RITO 1426	89	+2.1	+58	+90	+27	+33	+68	43	42
Lot 3-693	11-Apr	18830 976	PREMIER	SHAMROCKS RITO 1426	83	+3.2	+44	+89	+26	+36	+95	-	38
Lot 4-6101	12-Apr	18830 981	CAPITALIST	DIAMOND STEAKHOUSE	92	+2.2	+63	+101	+22	+34	+48	40	40
Lot 5-631	31-Mar		CONVEYANCE	HOOVER DAM	83							37	43
Lot 6-6163	29-Apr		CONVEYANCE	HOOVER DAM	84							45	44
Lot 7-615	25-Apr	18830 987	BREAKOUT	DIAMOND STEAKHOUSE 9378	67	+3	+68	+124	+27	+64	+56	38	36
Lot 8-6168	30-Apr	18830 991	CAPITALIST	STEVENSONS MONEY MAKER U6026	87	+2.1	+62	+101	+23	+33	+44	35	39
Lot 9-6140	20-Apr	18830 995	CAPITALIST	DIAMOND HOOVER DAM 0170	101	+2.2	+64	+162	+24	+35	+49	45	40
Lot 10-6119	16-Apr	18830 972	BREAKOUT	RIVERBEND COMPLETE 681	79	+4	+69	+123	+26	+65	+38	36	38
Lot 11-6117	16-Apr		CONVEYANCE		73							37	38
Lot 12-668	6-Apr	18830 989	R. CONSENSUS	DIAMOND HOOVER DAM 0170	85	+0.1	+57	+101	+26	+44	+75	40	37
Lot 13-629	30-Mar		CONVEYANCE	SAF 578 BANDO 5775	89							36	36
Lot 14-6145	23-Apr	18830 820	BREAKOUT	SUMMIT CREST COMPLETE 1P55	70	+4	+68	+120	+26	+66	+60	-	34
Lot 15-655	5-Apr	18830 825	PREMIER	SVF SHAMROCK PAY WEGHT 2535	82	+3.9	+44	+90	+25	+37	+98	45	38
Lot 16-622	27-Mar	18830 983	BREAKOUT	HOOVER DAM	71	+3	+68	+121	+27	+65	+58	37	43
Lot 17-6120	16-Apr		CONVEYANCE	BON VIEW NEW DESIGN 1407	82							40	41
Lot 18-603	17-Mar	18830 830	BREAKOUT	SVF SHAMROCK NEW DESIGN 254UN	78	+4	+69	+125	+28	+70	+55	42	42
Lot 19-662	6-Apr	18830 941	PREMIER	SAV HARVESTER 0338	79	+3.8	+44	+88	+25	+35	+95	36	39
Lot 20-6159	28-Apr	18830 954	PREMIER	JSAR DESIGN DOCTOR 280846	100	+4.2	+45	+89	+26	+36	+92	41	40
Lot 21-6155	26-Apr	18830 950	PREMIER		100	+4.0	+44	+90	+25	+34	+94	42	37

Jensen Angus High Mountain Bulls

Spring 2018 Private Treaty Bull Sale

Tattoo	Birth Date	Reg. No.	Sire Name	MGS Name	Actual BW	BW EPD	WW EPD	YW EPD	MILK EPD	CW EPD	MARB EPD	PAP 1	PAP 2
Lot 22-652	18-Apr	18830 949	PREMIER	MAGNUM 815 EAR	93	+3.9	+43	+89	+26	+.35	+.95	39	37
Lot 23-6173	6-May	18830 992	CAPITALIST		87	+2.1	+64	+164	+22	+.34	+.48	43	42
Lot 24-658	5-Apr	18830 962	CAPITALIST	SHAMROCK BH0? 1426	88	+2.2		+103	+23	+.35	+.49	40	45
Lot 25-6169	14-Apr	18830 993	R. CONSENSUS	ER FOCUS K216	89	+2.7	+57	+102	+25	+.44	+.76	37	37
Lot 26-6136	19-Apr	18830 986	PREMIER	GAR RETAIL PRODUCT	92	+4.0	+45	+89	+26	+.37	+.93	34	33
Lot 27-671	8-Apr	18830 951	CAPITALIST	SVF SHAMROCK PAYWEIGHT 253T	88	+2.1		+105	+22	+.34	+.50	42	44
Lot 28-625	28-Mar		CONVEYANCE	EXARUPGHOT 656	83							39	37
Lot 29-6158	27-Apr	18831 015	CAPITALIST	BON VIEW NEW DESIGN 208	89	+2.0		+63	+23	+.34	+.48	42	36
Lot 30-6153	24-Apr		CONVEYANCE	SVF SHAMROCK NEW DESIGN 254U	79		+64					36	39
Lot 31-6164	30-Apr	18830 994	PREMIER	SHAMROCKS MENTOR 1425	92	+4.0	+45	+89	+26	+.35	+.95	40	37
Lot 32-695	11-Apr	18830 831	R. CONSENSUS	BON VIEW NEW DESIGN 208	83	+2.6	+57	+102	+24	+.45	+.76	39	37
Lot 33-623	08-Mar	18830 952	BREAKOUT	SHAMROCKS NEW DESIGN 254UL	82	+.3	+68	+120	+27	+.64	+.57	-	41
Lot 34-691	18-Apr	18830 999	R. CONSENSUS	CONNEL GRIDLINE	87	+2.8	+44	+89	+25	+.31	+.65	37	38
Lot 35-605		18830 996	CAPITALIST	OCC GRIDLINE 1101	82	+.4		+124	+26	+.64	+.58	35	36
Lot 36-6113	15-Apr	18830 955	PREMIER	SFTZ TRAVELER 10619	90	+3.9	+44	+88	+27	+.36	+.94	37	35
Lot 37-6191	1-Jun	18831 001	CAPITALIST		81	+2.1		+102	+23	+.34	+.50	35	39
Lot 38-664	6-Apr		CONVEYANCE	SIT2 UPWARD 307R	69							40	40
Lot 39-6118	16-Apr		CONVEYANCE	SVP SHAMROCK PAY WEIGHT 253+	69							42	41
Lot 40-6116	16-Apr		CONVEYANCE	RIVERBEND COMPLEX X681	73							39	37
Lot 41-6149	24-Apr	18831 005	BREAKOUT	SVF SHAMROCK COPYRIGHT 492L	171	+.4	+69	+125	+27	+.65	+.57	39	38
Lot 42-6192	1-Jun	18830 998	CAPITALIST	SHAMROCK MENTOR 1425	79	+.22	+64	+106	+22	+.35	+.48	40	36

Jensen Angus High Mountain Bulls

Spring 2018 Private Treaty Bull Sale

Tattoo	Birth Date	Reg. No.	Sire Name	MGS Name	Actual BW	BW EPD	WW EPD	YW EPD	MILK EPD	CW EPD	MARB EPD	PAP 1	PAP 2
Lot 43-6126	18-Apr	18831 007	R. CONSENSUS	LEADORE HIGH COUNTRY 81	83	+2.6	+57	+102	+24	+45	+75	37	40
Lot 44-6143	21-Apr	18830 982	PREMIER	ER FOCUS 1C26	94	+4.1	+46	+88	+26	+37	+94	39	40
Lot 45-6112	15-Apr	18830 937	CAPITALIST	SAV TRAVELER 8180 64	89	+2.2		+107	+23	+34	+49	41	41
Lot 46-6157	27-Apr	18830 832	CAPITALIST	CRA BEXTOR 872 5205 608	85	+2.1		+106	+22	+35	+48	40	37
Lot 47-6179	7-May		CONVEYANCE	LUCE 7 MENTER 4127	72		+44					44	44
Lot 48-6150	24-Apr	18830 837	BREAKOUT	LUCE 7 PATRIOT 631	74	+3	+69	+124	+28	+64	+58		40
Lot 49-643	1-Apr		CONVEYANCE	GAR RETAIL PRODUCT	87	+4	+57	+125	+26	+65	+37	39	39
Lot 50-634	31-Mar	18830 956	R. CONSENSUS	BPF IN FOCUS 542	73	+2.6	+44	+103	+25	+45	+75	35	45
Lot 51-6151	24-Apr	18830 944	BREAKOUT	SHAMROCK COPYRIGHT 492	77	+4	+68	+124	+27	+66	+58	32	43
Lot 52-638	31-Mar		CONVEYANCE	BON VIEW NEW DESIGN P807	77		+40					-	38
Lot 53-6117	16-Apr		CONVEYANCE	SUMMIT CREST COMPLETE 1P53	73		+42					37	38
Lot 54-6160	28-Apr	18830 836	PREMIER	SVF SHAMROCK PAY WEIGHT 253T	93	+4.6	+44	+800	+26	+37	+94	-	38
Lot 55-6146	23-Apr	18830 959	BREAKOUT	STEVENSONS MONEY MAKER U0602U	72	+4	+68	+125	+27	+66	+58	43	41
Lot 56-6188	25-May	18830 960	CAPITALIST	ER FOCUS J049	81	+2.1	+41	+165	+23	+35	+50	38	41
Lot 57-6129	18-Apr	18830 988	PREMIER	LUAC47 MAXIMUM 648	85	+3.8	+44	+88	+26	+37	+96	-	40
Lot 58-670	18-Apr	18830 990	PREMIER	DIAMOND STEAKHOUSE 9378	73	+3.1	+45	+89	+25	+36	+95	39	37
Lot 59-694	11-Apr	18831 008	PREMIER	ADAMS ACRES OMEGA 325	97	+4.1	+43	+98	+26	+35	+94	38	40
Lot 60-686	10-Apr	18831 000	CAPITALIST	LEADORE HIGH COUNTRY 81	81	+2.1	+62	+106	+22	+34	+48	36	38
Lot 61-696	11-Apr	18831 010	CAPITALIST	ER FOCUS J049	82	+2.2	+63	+107	+23	+35	+49	39	36



Jensen Angus

High Quality Mountain Bulls

Justin & Renee Jensen

307-367-2510

PO Box 316

Boulder, WY 82923

Jensen Angus
High Quality Mountain Bulls

