

143 CHIZZLER ROAD

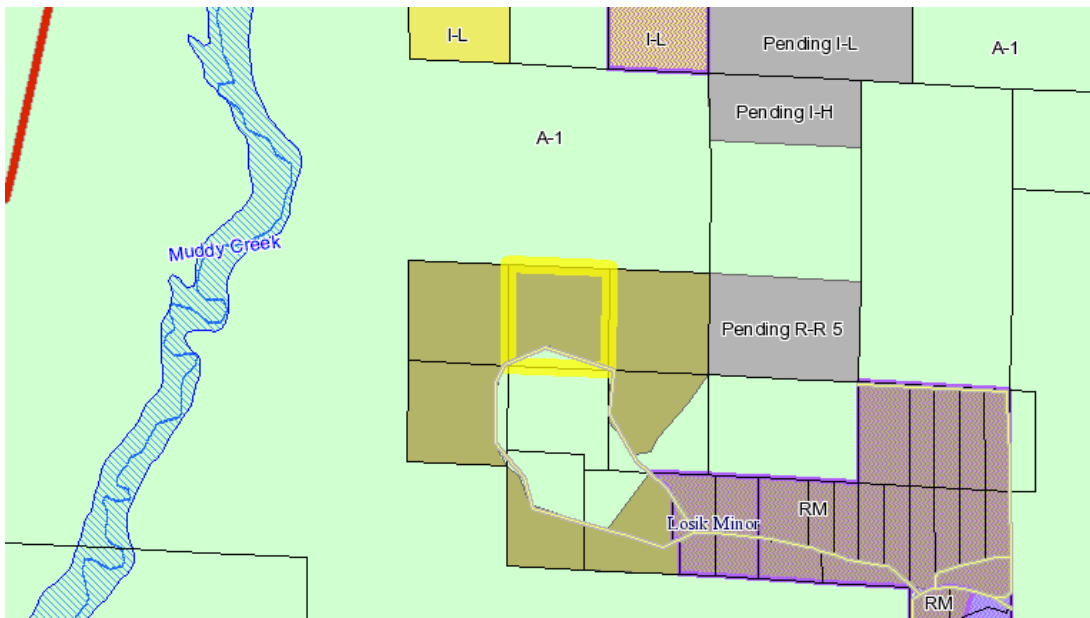

Discover one of Big Piney's warm and inviting log homes. 4 bedrooms/3 bathrooms, open kitchen and dining area, and a living room with a vaulted aspen ceiling. Wrap around decks invites relaxation, peace, and spectacular views. Bordering alongside BLM land, Muddy Creek is a close horse ride away.





143 Chizzler Road borders BLM Public Land



Address: 143 Chizzler Road, Big Piney WY

Legal: T30N R111W SEC10 SWNE

Homeowners: None, No restrictions

Size: 39.64 acres

Square Feet: Approx 2,464

Year Built: 2008

Bedrooms: Four

Bath: 2 full, 1 $\frac{3}{4}$

Garage: Attached 2 individual bays, approx 576 sq. ft.

Utilities: Phone, Electric

Water: Private well / Septic

12 Taxes: ~\$1880.00

Zoning: Rural-Mixed Use Residential allows for unique business uses

Nearest Public Land: BLM

Area Elevation: Approx 6889 feet

MLS Number: 12-636

List Price: \$399,000

General Contractor: Scott Marshall, Builder

For a private tour and to request more pictures, contact Serese Kudar, 307-231-2716